

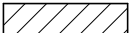

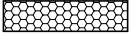



LEGENDA:

	Novatop panel
	Dřevoláknitá izolace
	Fermacell Firepanel
	Fasádní prkna
	Extrudovaný polystyren
	Litý anhydrit
	Železobeton
	Prostý beton
	Kačírek
	Štěrka
	Štěrkořt
	Vegetační substrát
	Hydroizolace
	Difúzně otevřená folie
S XX	Stěny - viz tabulka
R XX	Střechy - viz tabulka
P XX	Podlahy - viz tabulka
K XX	Klempířské prvky - viz tabulka

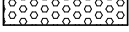
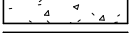
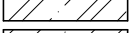
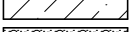

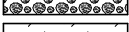
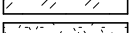
±0,000 = 365 m.n.m.

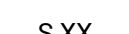
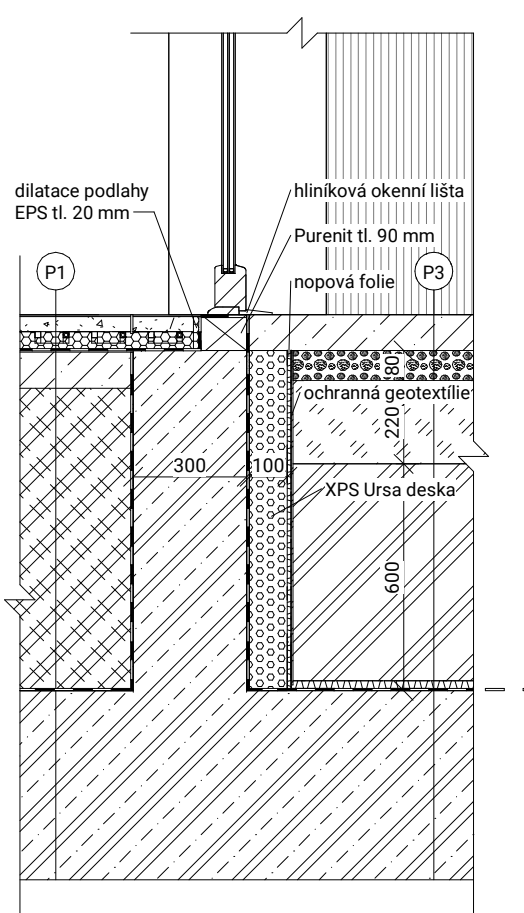
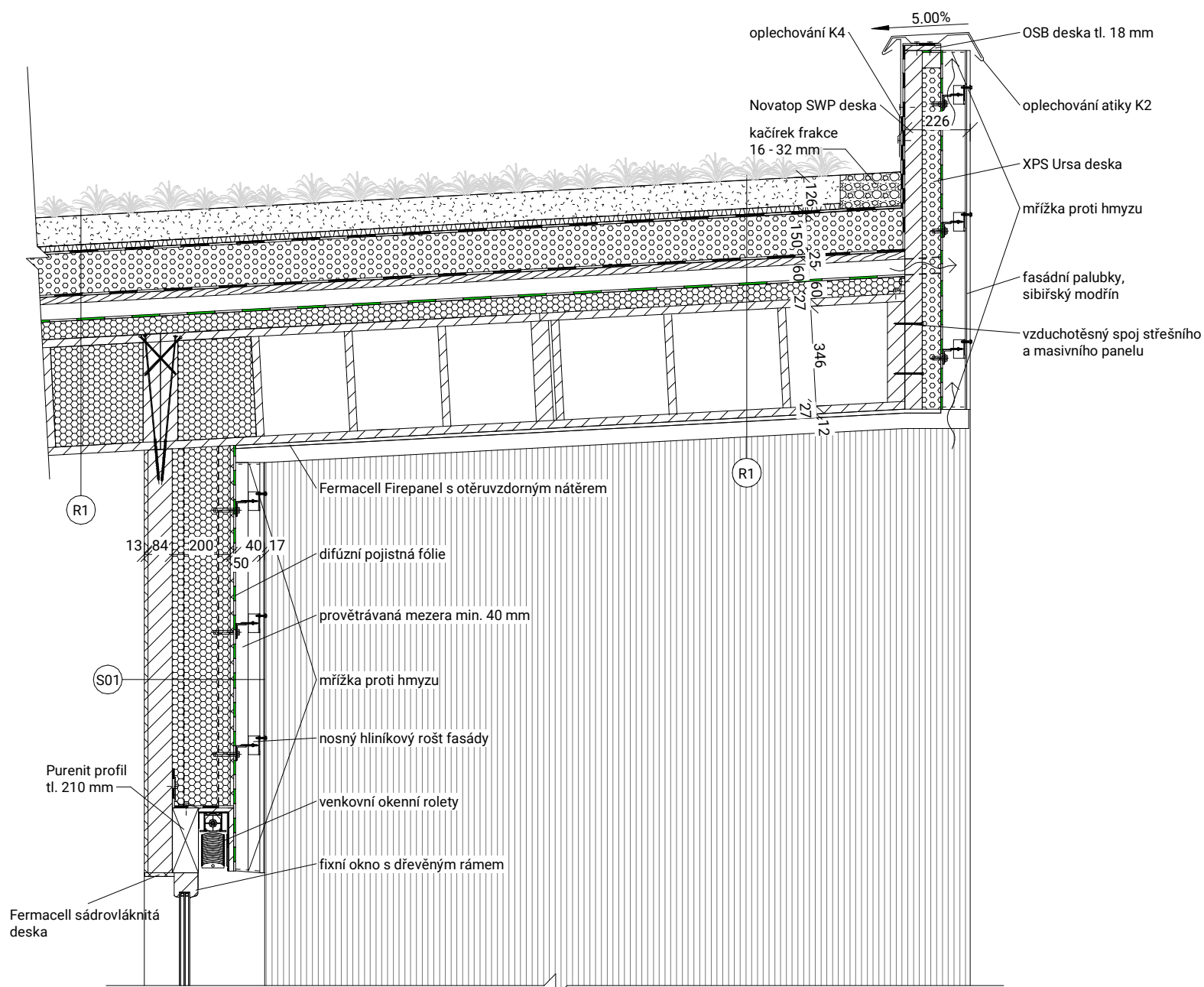
Bakalářská práce

Název projektu:

Mateřská škola Hostivice
- Mají si kde hrát!

Univerzita:

České vysoké učení technické
Fakulta architektury
Ústav navrhování II

Thákurova 9
166 34 Praha 6



Vedoucí ústavu:

doc. Ing. arch. Dalibor Hlaváček, Ph.D.

Vedoucí bakalářské práce:

Ing. arch. Štěpán Valouch

Konzultant:

Ing. arch. Marek Pavlas, Ph.D.

Část:

Architektonicko-stavební řešení

Vypracoval: Měřitko:

Vojtěch Trochta 1:20

Název výkresu: Číslo:

Detailní řez fasádou 1 D.1.b.4.1